

型號及代碼 Model & Code

型號MODEL		面板尺寸Dimension		代碼 CODE								
		①	②	③	④	⑤	*	⑥	⑦	⑧	⑨	
TH102	48×48mm	<input type="checkbox"/>	<input type="checkbox"/>	<input type="checkbox"/>	<input type="checkbox"/>	<input type="checkbox"/>	<input type="checkbox"/>	<input type="checkbox"/>	<input type="checkbox"/>	<input type="checkbox"/>	<input type="checkbox"/>	
TH402	48×96mm	<input type="checkbox"/>	<input type="checkbox"/>	<input type="checkbox"/>	<input type="checkbox"/>	<input type="checkbox"/>	<input type="checkbox"/>	<input type="checkbox"/>	<input type="checkbox"/>	<input type="checkbox"/>	<input type="checkbox"/>	
TH502	96×48mm	<input type="checkbox"/>	<input type="checkbox"/>	<input type="checkbox"/>	<input type="checkbox"/>	<input type="checkbox"/>	<input type="checkbox"/>	<input type="checkbox"/>	<input type="checkbox"/>	<input type="checkbox"/>	<input type="checkbox"/>	
TH702	72×72mm	<input type="checkbox"/>	<input type="checkbox"/>	<input type="checkbox"/>	<input type="checkbox"/>	<input type="checkbox"/>	<input type="checkbox"/>	<input type="checkbox"/>	<input type="checkbox"/>	<input type="checkbox"/>	<input type="checkbox"/>	
TH902	96×96mm	<input type="checkbox"/>	<input type="checkbox"/>	<input type="checkbox"/>	<input type="checkbox"/>	<input type="checkbox"/>	<input type="checkbox"/>	<input type="checkbox"/>	<input type="checkbox"/>	<input type="checkbox"/>	<input type="checkbox"/>	
1 控制方式Control action												
PID反作用 (加熱) 自動演算 PID/autotuning (heating F)												
PID正作用 (冷卻) 自動演算 PID/autotuning (Cooling D)												
2 輸入類型 Input type (參見A**"輸入範圍表")												
3 量程範圍 Range code (See A**"INPUT RANGE TABLE")												
4 主控制輸出(OUT)												
Control output (OUT)												
無主輸出 No output		N										
繼電器接點輸出 Relay contact		M										
電壓脈衝 (接固態繼電器) Voltage pulse		V										
可控硅單相過零觸發 Trigger (Zero trigger for triacs driving)		T										
DC4-20mA PID		8										
DC0-5VDC PID		5										
DC0-10VDC PID		6										
5 變送輸出 Retransmission												
無變送輸出 No transmission		N										
變送測量值4-20mA PV transmission 4-20mA		C										
變送測量值0-5VDC PV transmission 0-5VDC		P										
變送測量值0-10VDC PV transmission 0-10VDC		Q										
變送設定值4-20mA SV transmission 4-20mA		E										
變送設定值0-5VDC SV transmission 0-5VDC		R										
變送設定值0-10VDC SV transmission 0-10VDC		S										
6 報警1報警模式(AL1), Alarm1		7 報警2報警模式(AL2), Alarm2										
無報警 No Alarm				N N								
偏差高報警 Deviation high alarm				A A								
偏差低報警 Deviation low alarm				B B								
偏差區間外報警 Deviation high/low alarm				C C								
偏差區間內報警 Deviation band alarm				D D								
偏差高報警(附待機功能) Deviation high alarm with hold action				E E								
偏差低報警(附待機功能) Deviation low alarm with hold action				F F								
偏差區間外報警(附待機功能) Deviation high/low alarm with hold action				G G								
偏差區間內報警(附待機功能) Deviation band alarm with hold action				M M								
絕對值高報警 Process high alarm				H H								
絕對值低報警 Process low alarm				J J								
絕對值高報警(附待機功能) Process high alarm with hold action				K K								
絕對值低報警(附待機功能) Process low alarm with hold action				L L								
8 供電電源, Power supply												
AC220V		A										
AC85~265V		B										
9 數字通訊 Communication												
無通訊功能 No communication		N										
RS-485通訊 (Modbus-RTU) RS-485 communication Modbus-RTU		M										

輸入範圍表 A** INPUT RANGE TABLE A**

輸入類型 Input type	代碼 Code
K	0 to 400 °C K A4
	0 to 600 °C K A6
	0 to 1300 °C K B3
E	0 to 400 °C E A4
	0 to 600 °C E A6
J	0 to 400 °C J A4
	0 to 800 °C J A8
T	0 to 200 °C T A2
	0 to 400 °C T A4

輸入類型 Input type	代碼 Code	
S ⁻¹ 0 to 1600 °C	S B6	
R 0 to 1700 °C	R B7	
B 200 to 1800 °C	B B8	
N 0 to 1300 °C	N B3	
Wu3_Re25 600 to 2000 °C	W B0	
輸入類型 Input type		代碼 Code
Pt100	0 to 400 °C	D A4
	0 to 800 °C	D A8
	-100 to +200 °C	D C2
	-200 to +800 °C	D C8

輸入類型 Input type	代碼 Code
0 to 20mV	V 01
0 to 50mV	V 02
0 to 5VDC	V 03
0 to 10VDC	V 04
1 to 5VDC	V 08
2 to 10VDC	V 09
4 to 20mA	A 03
0 to 20mA	A 02

(*) 0 to 400 °C: 精度不能保證。
 (*) 0 to 400 °C: Accuracy is not guaranteed.

外型尺寸及電氣配綫 Dimension and Hookup

TH102

DIN W48×H48 D80



尺寸 Dimension

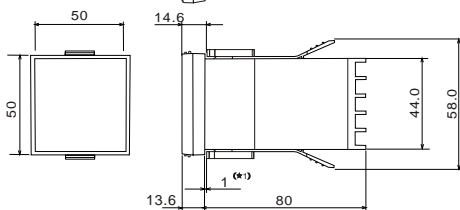

面板開孔 Panel Cutout

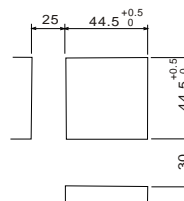

配綫圖 Hookup

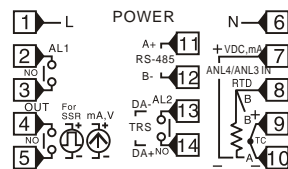

TH702

DIN W72×H72 D80



尺寸 Dimension

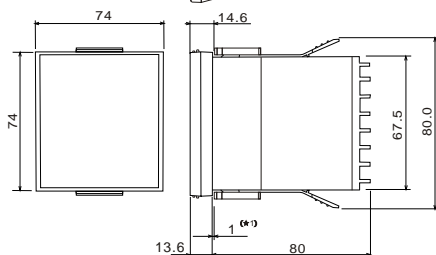

面板開孔 Panel Cutout

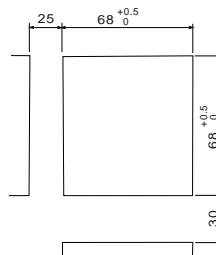

配綫圖 Hookup

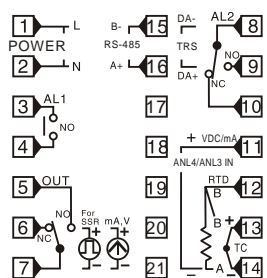

TH402

DIN W48×H96 D80



TH502



尺寸 Dimension

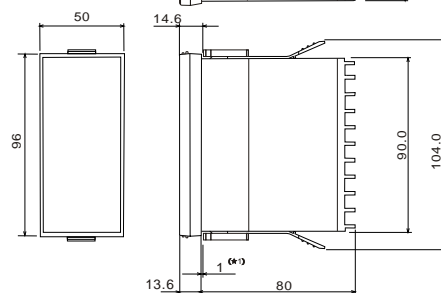

面板開孔 Panel Cutout

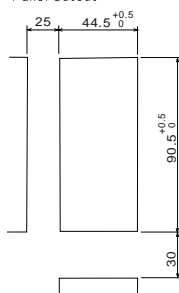

配綫圖 Hookup

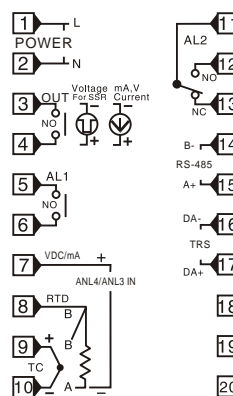

TH902

DIN W96×H96 D80



尺寸 Dimension

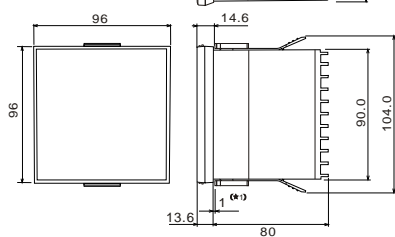

面板開孔 Panel Cutout

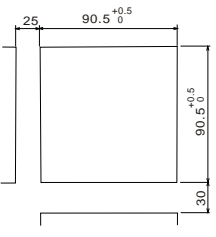

配綫圖 Hookup

